

WALL

WALL RECT RECESSED-8W-IP65-3000K-GRIS FONCE

PL16046503

OUTDOOR > Outdoor Wall Light

Rectangular aluminum recessed wall light for outdoor
beaconing.



Application domain

- Outdoor residential
- Garden
- Outdoor illumination



FILE UPDATED ON 27/01/2023

Electric data

Total power (W)	8
Rated voltage (V)	230V
Distorsion harmonique	-
Power factor	>0.9
Network frequencies	50Hz , 60Hz
Electric class	I
Dimmable	No

Photometric data

Color temperatures	3000K
Light source type	SMD
Including the light source	Yes
SDCM	SDCM>4
IRC	>80
Safety group (EN62778)	RG0
Luminous flux (lm)	330lm (3000K)
ULOR	-



FILE UPDATED ON 27/01/2023



Technical data

Dimensions (mm)	54 x 226 x 76
Weight (kg)	0.66
Recessed depth under BA13 (mm)	-
Cable length	-
Product color	Dark gray
IK Code	IK08
Incandescent wire test	650°C
IP Code	IP65
Use temperature range	-25... +45°
Body material	Aluminium
Diffuser material	PC
Driver included	Yes

Liefe time

L80 à 25°	35 000 h
-----------	----------

Supplementary data

Warranty period	5 years
Light beam spread	60°
Tiltable	No
Connection type	Connector on the product



FILE UPDATED ON 27/01/2023



Plan

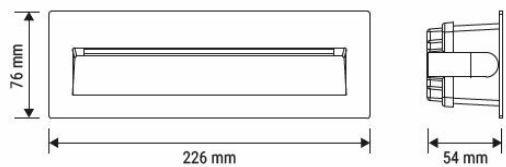

Accessories

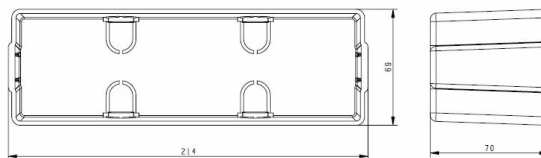

Atmosphere

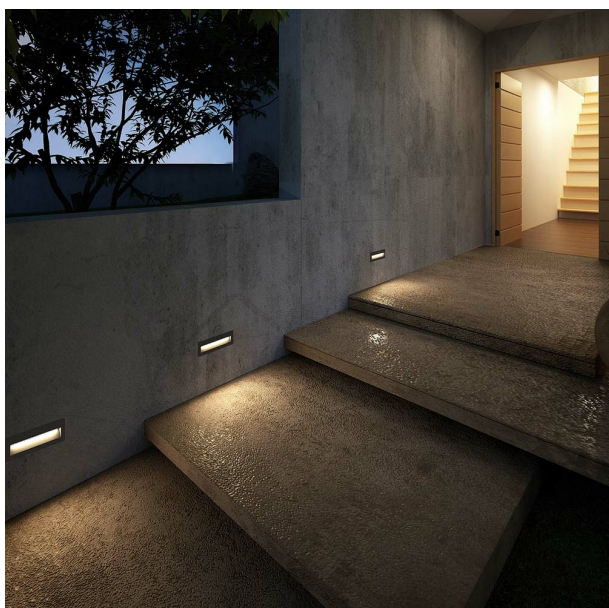

FILE UPDATED ON 27/01/2023

